



# Residential Product Catalog

## REMOTE HOME MANAGEMENT

### Be Home. Away From Home.

Schlage LiNK™ offers remote home management to control security and energy efficiency. Proven Z-Wave® technology supports the addition of up to 200 devices to customize the system to fit any lifestyle.

#### Security

- ANSI Grade 2 levers and deadbolts
- Remotely check status of locks – using cell phone or computer
- Remotely change or eliminate user codes at anytime
- Receive text messages or email alerts
- Provides audit trail – review history of who has entered home

#### Convenience

- Lock or unlock the door – manual deadbolt requires someone to be at the door
- Remotely control thermostats and lighting
- Allows up to 19 personal user codes per lock

#### Quality

- Lifetime Mechanical Warranty
- Lifetime Finish Warranty
- 1-Year Electronic Warranty



\*The Schlage LiNK™ Solution requires a monthly subscription fee to enable the remote access to a computer or cell phone over the internet.

Visit [link.schlage.com](http://link.schlage.com) for more information.



## ELECTRONIC SECURITY

### Go Keyless

Schlage's line of electronic locks offers flexibility and security without the need for keys. Just enter the personal 4-digit user code to unlock the keypad lock.

Upgrade to keypad locks for added flexibility and convenience.

#### Security

- ANSI Grade 2 keypad deadbolts and locks
- Eliminate lost keys
- Change or delete user codes at anytime
- Tamper alarm

#### Convenience

- No wiring required – installs in minutes with a screwdriver
- 3-Year 9V battery life
- Allows up to 19 personal user codes
- Lighted keypad – for better visibility in the dark

#### Quality

- Lifetime Mechanical Warranty
- Lifetime Finish Warranty – all finishes excluding Oil Rubbed Bronze
- 1-Year Electronic Warranty
- Epoxy coated buttons – numbers will not fade or show wear



#### BE365 Keypad Deadbolt

Awarded a Consumers Digest Best Buy rating recognizing it as the "toughest model on the market at this price" in the residential deadbolt lock category.

(February 2010)

## MECHANICAL SECURITY

## MECHANICAL SECURITY

### Professional Grade Security

With an impeccable attention to detail in every facet of the product's design and a passion for everyday use, Schlage has built a legacy of providing the highest level of security and convenience for more than 90 years.

#### Grade 1 Deadbolt

More security, more style and designed to install in a snap.

- Easy 3-Step Installation
- Anti-Pick Shield – A Schlage® Exclusive
- Bigger Bolt Diameter
- Three-Piece Design Snaps into Place
- ADA Code Compliant

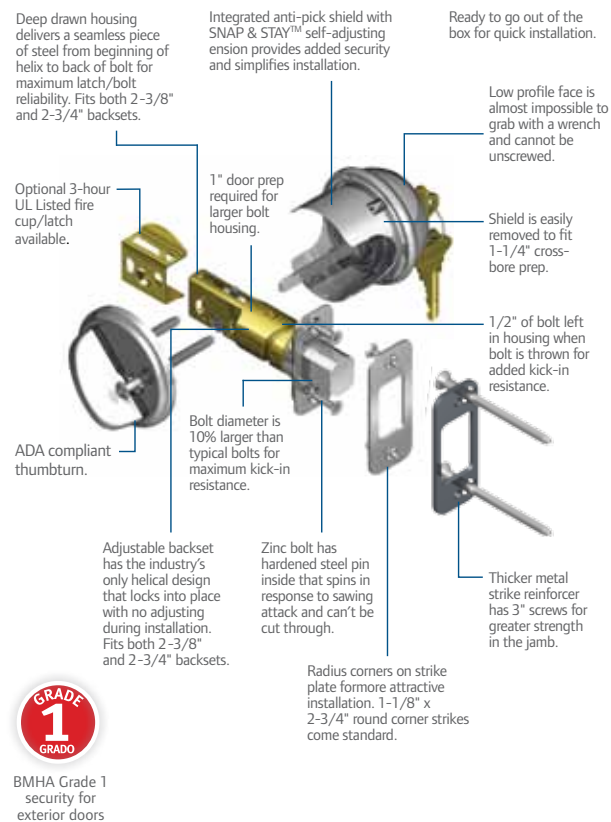

## NEW DECORATIVE COLLECTIONS

Door hardware becomes a work of art with Schlage's new collections. Five inspired designs, numerous finishes and a wide variety of lever and knob options create abundant combinations to suit any style.

Made with a solid die-cast construction, our new collections are not only visually appealing but solid and secure—exceeding ANSI Grade 2 standards—so you still get the security, convenience and quality you've come to depend on from Schlage.



Ingersoll Rand Residential Solutions, a business comprised of well-known brands like Schlage and Trane, delivers safety, comfort and efficiency to homeowners throughout North America. Our quality products, services and solutions include mechanical and electronic locks, heating and air conditioning systems, indoor air quality solutions, advanced controls, portable security systems and remote home management.

800-847-1864

[www.ingersollrand.com](http://www.ingersollrand.com)  
[www.schlage.com](http://www.schlage.com)  
[www.trane.com](http://www.trane.com)



© 201 Ingersoll-Rand Company  
All rights reserved.

MR-2019  
05/11

## SCHLAGE® LINK STARTER KITS



Schlage LiNK™ Starter Kit includes your choice of deadbolt or keypad lever lock, light module, and bridge.

Finishes:  
605 Bright Brass  
619 Satin Nickel  
716 Aged Bronze

Be Secure.  
Be Efficient.  
Be Informed.



## SCHLAGE® LINK ACCESSORIES



#### Schlage® Light and Appliance Modules

- Signal range 60–100 ft
- UL Listed
- Provide 1 Z-Wave controlled and 1 standard AC outlet
- For indoor use only
- Supports Z-Wave beaming protocol
- Can be used to expand Schlage® LiNK System Range

SPECIFICATIONS	Schlage® Light Module	Schlage® Appliance Module
Compatibility	Incandescent and Halogen bulbs only	CFL, Fluorescent, Incandescent bulbs and small appliances
Dimming Capability	Yes	No
Maximum Load Z-Wave Outlet	300W	600W, 1/2 HP motor
Maximum Load Combined Outlet	15A, 1800W	15A, 1800W



#### Trane® Remote Energy Management System

- Remotely control your home's heating and cooling through the Schlage LiNK web portal
- 7 day programmable thermostat with up to 4 settings per day
- Compatible with most brands of HVAC systems
- FCC approved
- Works with any Z-Wave controller supporting thermostats



#### Schlage® Wireless Camera

- Remotely monitor your home allowing you to stay in touch and in control
- Specifically designed to work with the Schlage LiNK™ System for secure connection and ease of use
- Available in wireless or wired options

## SCHLAGE KEYPAD PRODUCTS

\*Additional finishes available special order.



Camelot Keypad Deadbolt

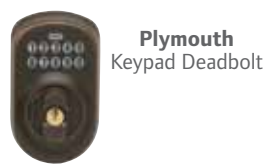

Plymouth Keypad Deadbolt



Camelot Keypad Lever  
FE285 Camelot Grip



Plymouth Keypad Lever  
FE285 Plymouth Grip

## Adjustable throughbolt

Schlage handlesets feature a patented adjustable throughbolt for simple and easy installation and a guaranteed fit.

- Throughbolt on handlesets can move up and down 1 1/2" to fit a variety of pre-existing holes
- Handlesets can retrofit over 70 percent of competitors' current designs
- Eliminates re-drilling



8 3/8" Travel  
1 1/2" Travel  
9 7/8"



